

WEDGEWOOD GARDENS CONDOMINIUM ASSOCIATION

VERONA, NEW JERSEY

Pavement Improvement Project

Index of Pages

Sheet Number	Description	Dated	Revised
Sheet 1	Cover Sheet	Aug 14, 2023	September 12, 2025
Sheet 2	Pavement Improvement Plan	Aug 14, 2023	September 12, 2025
Sheet 3	Pavement Striping Plan	Aug 14, 2023	
Sheet 4	Construction Details 1	Aug 14, 2023	
Sheet 5	Construction Details 2	Aug 14, 2023	

CONSTRUCTION NOTES:

- UTILITIES SHOWN ON THIS PLAN ARE APPROXIMATE AND NOT COMPLETE AND LOCATIONS HAVE NOT BEEN VERIFIED. ADJUSTMENTS TO PROPOSED STORM SEWER WORK MAY NEED TO BE MADE IF CONFLICTS EXIST. NOTIFY ENGINEER IMMEDIATELY IF CONFLICTS EXIST. CONTRACTOR IS RESPONSIBLE FOR LOCATION, PROTECTION, AND RELOCATION OF ALL UNDERGROUND UTILITIES INCLUDING SPRINKLERS AND PRIVATE UTILITIES AS REQUIRED TO COMPLETE WORK.
- CONTRACTOR IS RESPONSIBLE FOR OBTAINING ALL APPLICABLE PERMITS AND ANY FEES ASSOCIATED WITH SAME SHALL BE PAID BY THE ASSOCIATION.
- CONTRACTOR SHALL BE RESPONSIBLE FOR PUMPING AND DRAINAGE OF TRENCHES THAT MAY BE REQUIRED TO COMPLETE WORK.
- CONTRACTOR SHALL BE RESPONSIBLE TO SECURE AND BARRICADE WORK(S) AREA(S) AT THE COMPLETION OF EACH DAY TO THE SATISFACTION OF THE ENGINEER.
- OWNER SHALL MAKE AVAILABLE AN ON-SITE AREA FOR THE STOCKPILE OF EQUIPMENT AND SUPPLIES. CONTRACTOR SHALL BE RESPONSIBLE FOR MAINTENANCE AND SAFETY OF THIS AREA EACH DAY.
- CONTRACTOR SHALL BE RESPONSIBLE FOR PROTECTION OF EXISTING BUILDINGS AND LANDSCAPING AS NEEDED TO COMPLETE WORK.
- ALL AREAS OF DISTURBANCE SHALL BE TOPSOILED AND SEEDED AS DIRECTED BY ENGINEER.
- ALL UNUSED EXCAVATED SOIL AND MATERIALS SHALL BE REMOVED FROM SITE AND PROPERLY DISPOSED.
- NO VEHICLES SHALL BE STORED IN ROADWAYS WITHOUT OWNER'S APPROVAL.
- CONTRACTOR SHALL CLEAN PARKING AREAS AND/OR ROADWAYS EACH DAY OR AS REQUIRED.
- CONTRACTOR SHALL PROVIDE TEMPORARY TOILET FACILITIES FOR DURATION OF WORK IN APPROVED LOCATION.
- ROADWAY AND DRIVEWAY LOCATIONS, PIPE DEPTHS, ETC. ARE SCHEMATIC. CONTRACTOR SHALL BE RESPONSIBLE TO VERIFY ALL QUANTITIES PRIOR TO BIDDING PROJECT.
- DESIGN IS SCHEMATIC. CONTRACTOR SHALL BE RESPONSIBLE TO VERIFY EXISTING CONDITIONS PRIOR TO BIDDING PROJECT.
- ELEVATIONS SHOWN ARE BASED UPON ASSUMED DATUM AND ARE RELATIVE TO THE IMPROVEMENT AREA AND SPECIFIC DRIVEWAY LOCATIONS ONLY.
- ALL PROPOSED WORK SUBJECT TO ALL LOCAL, STATE, AND FEDERAL APPROVALS PRIOR TO START OF WORK.
- ALL MATERIALS AND METHODS OF CONSTRUCTION SHALL BE IN ACCORDANCE WITH CONTRACT PLANS AND SPECIFICATIONS OR NJDOT SPECIFICATIONS FOR ROAD AND BRIDGE CONSTRUCTION. CONTRACTOR RESPONSIBLE FOR ADHERENCE TO SAME, AS CURRENTLY AMENDED AND ALL LOCAL ORDINANCES AND REQUIREMENTS.
- FALCON ENGINEERING AND THE ASSOCIATION SHALL NOT BE HELD RESPONSIBLE FOR INSPECTION OR IMPLEMENTATION OF JOB SAFETY REQUIREMENTS. CONTRACTOR IS SOLELY RESPONSIBLE FOR ALL SAFETY REQUIREMENTS INCLUDING STRICT ADHERENCE TO OSHA REQUIREMENTS.
- CONTRACTOR RESPONSIBLE TO CLEAN ALL AREAS FROM DIRT AND/OR DEBRIS AS NEEDED.
- ALL CONCRETE SHALL BE REMOVED AND DISPOSED OF IN AN APPROVED MANNER.
- ALL CONCRETE IS SUBJECT TO APPROVAL BY OWNER PRIOR TO PAYMENT.
- LIMITS OF ALL CONCRETE WORK TO BE MARKED IN FIELD AND APPROVED PRIOR TO START OF WORK.
- CONCRETE SHALL COMPLY WITH APPLICABLE ACI SPECIFICATIONS.
- NO CONCRETE WORK SHALL BE PERFORMED WHEN WHEN TEMPERATURE IS BELOW FORTY (40) DEGREES FAHRENHEIT.
- APPROVED METHODS OF PLACING, FINISHING, AND CURING SHALL BE USED WHEN AIR TEMPERATURE IS IN EXCESS OF NINETY (90) DEGREES OR WINDY CONDITIONS EXIST.

NOTE:

- PLANS ARE SUBMITTED TO TOWNSHIP FOR THE PURPOSES OF SHOWING THE TOWNSHIP ENGINEER REQUESTED ADDITIONAL CATCH BASINS TO ALLEVIATE ANY POTENTIAL DRAINAGE ISSUES.

PROJECT LOCATION

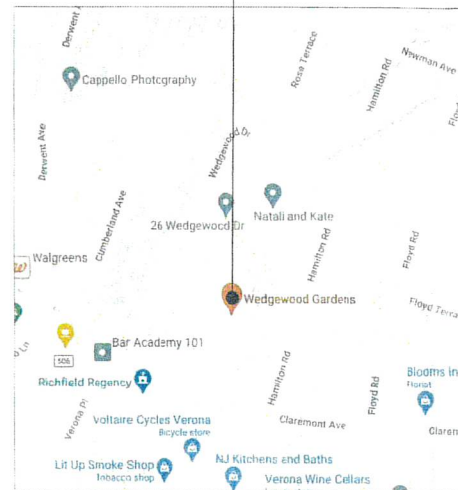

VICINITY MAP

SCALE: N.T.S.

THE FALCON GROUP

ENGINEERING, ARCHITECTURE
& ENERGY CONSULTANTS

NJ • NY • PA • CT • DC •
MD • VA • DE • FL

95 Mount Bethel Road
Warren, NJ 07059
Phone: 908-595-0050
Fax: 908-595-0012

COA# 24GA28083800

THIS PLAN IS NOT VALID UNLESS IT CONTAINS
AN ORIGINAL SIGNATURE BY AN ENGINEER
AND CONTAINS A PROFESSIONAL SEAL.

DESIGN IS SCHEMATIC. CONTRACTOR SHALL BE
SOLELY RESPONSIBLE TO VERIFY ALL EXISTING
DIMENSIONS AND CONDITIONS.

COPYRIGHT 2023 FALCON ENGINEERING Co., LLC,
ALL RIGHTS RESERVED

THIS DRAWING AND ALL THE INFORMATION
CONTAINED HEREIN IS AUTHORIZED FOR USE
ONLY BY THE PARTY, FOR WHOM THE WORK
WAS CONTRACTED, TO WHOM IT IS CERTIFIED.
THIS DRAWING MAY NOT BE COPIED, REUSED,
DISCLOSED, DISTRIBUTED OR RELIED UPON FOR
ANY OTHER PURPOSE WITHOUT THE EXPRESS
WRITTEN CONSENT OF FALCON ENGINEERING.

DRAFTED BY: DJD PROJECT #: 10-243

REVIEWED BY: DC SCALE: AS NOTED SHEET SIZE: 24"x36"

INIT.	NO.	DATE	ISSUED
LT	1	08/14/23	FOR CLIENT REVIEW
BC	2	10/03/23	BID SET ISSUE

INIT.	NO.	DATE	REVISION
DJD	1	09/12/25	PLANNING BOARD SUBMISSION

CONSULTANT:

ANDREW AMOROSI
Professional Engineer NJ: #24GE03862600

Title Sheet

Wedgewood Gardens CA
Pavement Improvement
Verona, New Jersey

T-1

SHEET 1 OF 5

LEGEND:

EXISTING	PROPOSED

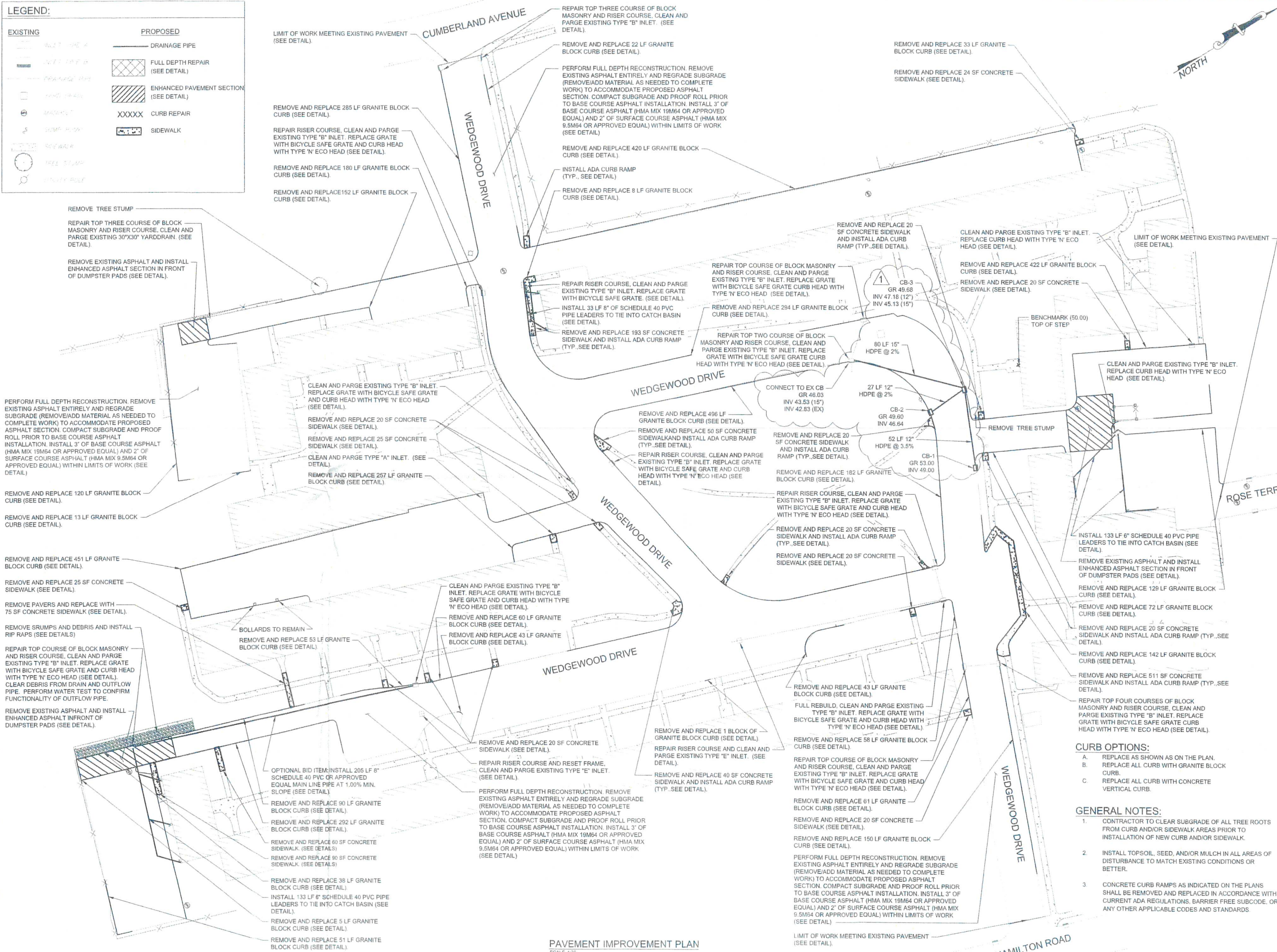

THE FALCON GROUP

ENGINEERING, ARCHITECTURE & ENERGY CONSULTANTS

NJ • NY • PA • CT • DC • MD • VA • DE • FL

95 Mount Bethel Road
Warren, NJ 07059
Phone: 908-595-0050
Fax: 908-595-0012

COA# 24GA28083800

THIS PLAN IS NOT VALID UNLESS IT CONTAINS AN ORIGINAL SIGNATURE BY AN ENGINEER AND CONTAINS A PROFESSIONAL SEAL.

DESIGN IS SCHEMATIC, CONTRACTOR SHALL BE SOLELY RESPONSIBLE TO VERIFY ALL EXISTING DIMENSIONS AND CONDITIONS.

COPYRIGHT 2023 FALCON ENGINEERING Co., LLC. ALL RIGHTS RESERVED

THIS DRAWING AND ALL THE INFORMATION CONTAINED HEREIN IS AUTHORIZED FOR USE ONLY BY THE PARTY, FOR WHOM THE WORK WAS CONTRACTED, TO WHOM IT IS CERTIFIED. THIS DRAWING MAY NOT BE COPIED, REUSED, DISCLOSED, DISTRIBUTED OR RELIED UPON FOR ANY OTHER PURPOSE WITHOUT THE EXPRESS WRITTEN CONSENT OF FALCON ENGINEERING.

DRAFTED BY:	PROJECT #:
DJD	10-243

REVIEWED BY:	SCALE:	SHEET SIZE:
DC	AS NOTED	24"x36"

INIT.	NO.	DATE	ISSUED
LT	1	08/14/23	FOR CLIENT REVIEW
BC	2	10/03/23	BID SET ISSUE

INIT.	NO.	DATE	REVISION
DJD	1	09/12/25	PLANNING BOARD SUBMISSION

CONSULTANT:

ANDREW AMOROSI
Professional Engineer NJ: #24GE03862600

Pavement Improvement Plan

Wedgewood Gardens CA
Pavement Improvement
Verona, New Jersey

C-1

SHEET 2 OF 5

PAVEMENT IMPROVEMENT PLAN
SCALE: 1"=30'

CUMBERLAND AVENUE

STOP

WEDGEWOOD DRIVE

INSTALL 12" WIDE WHITE STOP BAR WITH "STOP" PAVEMENT MARKING IN LOCATIONS AS SHOWN TO MATCH EXISTING (TYP.)

INSTALL 4" WIDE WHITE PARKING STRIPE ADJACENT TO YELLOW NO PARKING AREA IN LOCATIONS TO MATCH EXISTING OR AS APPROVED BY OWNER.

INSTALL 4" WIDE YELLOW LINE STRIPING IN LOCATIONS AS SHOWN TO MATCH EXISTING OR AS APPROVED BY OWNER (TYP.).

INSTALL 4" WIDE YELLOW LINE STRIPING IN LOCATIONS AS SHOWN TO MATCH EXISTING OR AS APPROVED BY OWNER (TYP.).

INSTALL 4" WIDE YELLOW LINE STRIPING WITH CROSS HATCH IN LOCATIONS AS SHOWN TO MATCH EXISTING OR AS APPROVED BY OWNER (TYP.).

INSTALL 4" WIDE WHITE PARALLEL PARKING STRIPING. STALLS TO BE 8' BY 24' (TYP.).

INSTALL 4" WIDE YELLOW LINE STRIPING AND HATCH IN LOCATIONS AS SHOWN TO MATCH EXISTING OR AS APPROVED BY OWNER (TYP.).

INSTALL 4" WIDE YELLOW LINE STRIPING IN LOCATIONS AS SHOWN TO MATCH EXISTING OR AS APPROVED BY OWNER (TYP.).

INSTALL 4" WIDE, 18" LONG, 9" O.C., WHITE LINE STRIPING TO MATCH EXISTING (TYP.).

INSTALL 4" WIDE YELLOW LINE STRIPING IN LOCATIONS AS SHOWN TO MATCH EXISTING OR AS APPROVED BY OWNER (TYP.).

INSTALL 4" WIDE YELLOW LINE STRIPING AND HATCH IN LOCATIONS AS SHOWN TO MATCH EXISTING OR AS APPROVED BY OWNER (TYP.).

INSTALL 4" WIDE YELLOW LINE STRIPING WITH CROSS HATCH IN LOCATIONS AS SHOWN TO MATCH EXISTING OR AS APPROVED BY OWNER (TYP.).

INSTALL 4" WIDE BLUE STRIPING WITH ADA SYMBOL AND LOADING ZONE IN ACCORDANCE WITH ADA REGULATIONS (TYP.) (SEE DETAIL).

INSTALL 4" WIDE WHITE PARALLEL PARKING STRIPING. STALLS TO BE 8' BY 24' (TYP.).

INSTALL 4" WIDE, 18" LONG, 9" O.C., WHITE LINE STRIPING TO MATCH EXISTING (TYP.).

INSTALL 4" WIDE YELLOW LINE STRIPING IN LOCATIONS AS SHOWN TO MATCH EXISTING OR AS APPROVED BY OWNER (TYP.).

ROSE TERR

WEDGEWOOD DRIVE

WEDGEWOOD DRIVE

WEDGEWOOD DRIVE

WEDGEWOOD DRIVE

HAMILTON ROAD

NORTH

GENERAL NOTES:

1. ALL LINE STRIPING TO MATCH EXISTING OR AS DIRECTED BY ENGINEER.
2. CONTRACTOR TO VERIFY LINE STRIPING PLAN WITH OWNER PRIOR TO STRIPING. ALL LINE STRIPING TO RECEIVE TWO COATS OF PAINT.

PAVEMENT IMPROVEMENT PLAN

SCALE 1/32"

SHEET 3 OF 5

1. ALL LINE STRIPING TO MATCH EXISTING OR AS DIRECTED BY ENGINEER.
2. CONTRACTOR TO VERIFY LINE STRIPING PLAN WITH OWNER PRIOR TO STRIPING. ALL LINE STRIPING TO RECEIVE TWO (2) COATS OF PAINT.

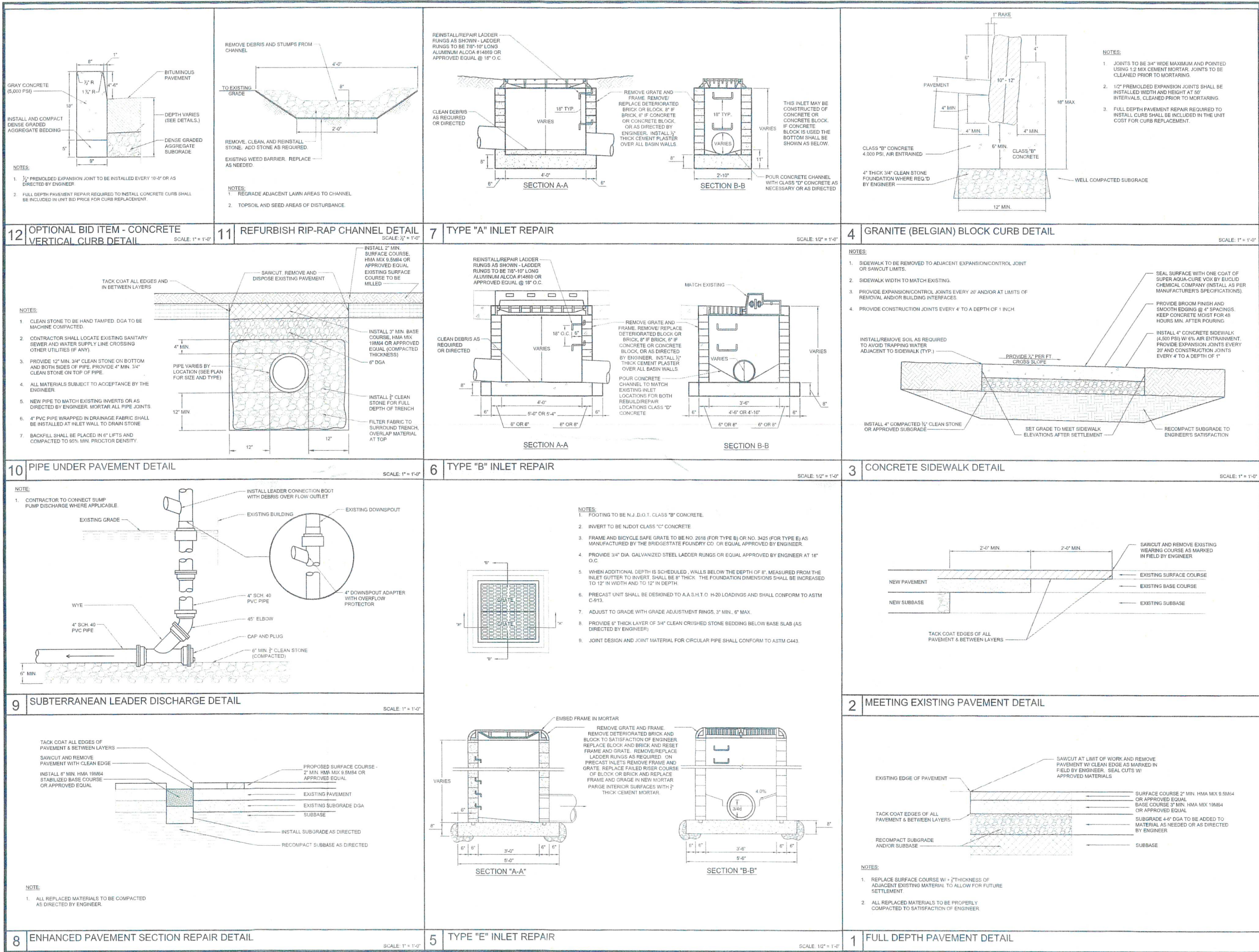

THE

FALCON

GROUP

ENGINEERING, ARCHITECTURE
& ENERGY CONSULTANTS

NJ • NY • PA • CT • DC •
MD • VA • DE • FL

95 Mount Bethel Road
Warren, NJ 07059
Phone: 908-595-0050
Fax: 908-595-0012

COA# 24GA28083800

THIS PLAN IS NOT VALID UNLESS IT CONTAINS
AN ORIGINAL SIGNATURE BY AN ENGINEER
AND CONTAINS A PROFESSIONAL SEAL.

DESIGN IS SCHEMATIC. CONTRACTOR SHALL BE
SOLELY RESPONSIBLE TO VERIFY ALL EXISTING
DIMENSIONS AND CONDITIONS.

COPYRIGHT 2023 FALCON ENGINEERING Co., LLC.
ALL RIGHTS RESERVED

THIS DRAWING AND ALL THE INFORMATION
CONTAINED HEREIN IS AUTHORIZED FOR USE
ONLY BY THE PARTY, FOR WHOM THE WORK
WAS CONTRACTED, TO WHOM IT IS CERTIFIED.
THIS DRAWING MAY NOT BE COPIED, REUSED,
DISCLOSED, DISTRIBUTED OR RELIED UPON FOR
ANY OTHER PURPOSE WITHOUT THE EXPRESS
WRITTEN CONSENT OF FALCON ENGINEERING.

DRAFTED BY:
DJD

PROJECT #:
10-243

REVIEWED BY:
DC

SCALE:
AS NOTED

SHEET SIZE:
24"x36"

INIT. NO. DATE ISSUED

LT 1 08/14/23 FOR CLIENT REVIEW

BC 2 10/03/23 BID SET ISSUE

INIT. NO. DATE REVISION

DJD 09/12/25 PLANNING BOARD SUBMISSION

CONSULTANT:

ANDREW AMOROSI
Professional Engineer NJ: #24GE03862600

Construction Detail
Plan 1

Wedgewood Gardens CA
Pavement Improvement
Verona, New Jersey

CD-1

SHEET 4 OF 5

THIS PLAN IS NOT VALID UNLESS IT CONTAINS
AN ORIGINAL SIGNATURE BY AN ENGINEER
AND CONTAINS A PROFESSIONAL SEAL.

DESIGN IS SCHEMATIC. CONTRACTOR SHALL BE
SOLELY RESPONSIBLE TO VERIFY ALL EXISTING
DIMENSIONS AND CONDITIONS.

COPYRIGHT 2023 FALCON ENGINEERING Co., LLC.
ALL RIGHTS RESERVED

THIS DRAWING AND ALL THE INFORMATION
CONTAINED HEREIN IS AUTHORIZED FOR USE
ONLY BY THE PARTY, FOR WHOM THE WORK
WAS CONTRACTED, TO WHOM IT IS CERTIFIED.
THIS DRAWING MAY NOT BE COPIED, REUSED,
DISCLOSED, DISTRIBUTED OR RELIED UPON FOR
ANY OTHER PURPOSE WITHOUT THE EXPRESS
WRITTEN CONSENT OF FALCON ENGINEERING.

DRAFTED BY:	DJD	PROJECT #:	10-243
REVIEWED BY:	DC	SCALE:	AS NOTED
		SHEET SIZE:	24"x36"
INT.	NO.	DATE	ISSUED
LT	1	08/14/23	FOR CLIENT REVIEW
BC	2	10/03/23	BID SET ISSUE

INT.	NO.	DATE	REVISION
DJD	Δ	09/12/25	PLANNING BOARD SUBMISSION

CONSULTANT:

ANDREW AMOROSI
Professional Engineer NJ: #24GE03862600

Construction Detail
Plan 2

Wedgewood Gardens CA
Pavement Improvement
Verona, New Jersey

CD-2

SHEET 5 OF 5

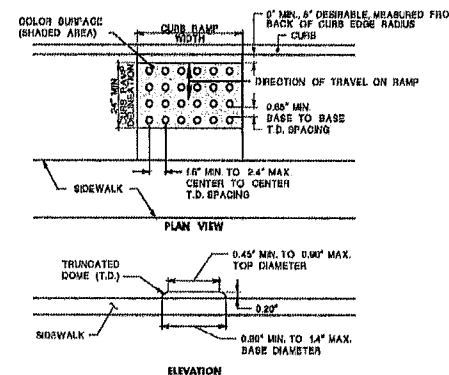

DETECTABLE WARNING SURFACE

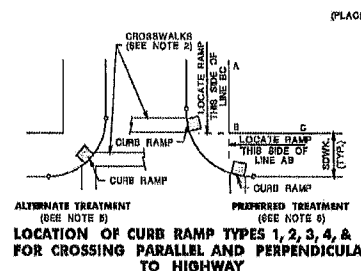

LOCATION OF CURB RAMP TYPES 1, 2, 3, 4, & 7
FOR CROSSING PARALLEL AND PERPENDICULAR
TO HIGHWAY

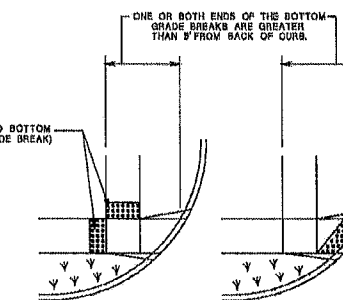
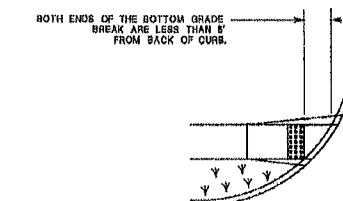

PLACEMENT OF DETECTABLE WARNING SURFACE
FOR CURB RAMP TYPE 5 AND 6

- NOTES:**
1. KEEP TURNING SPACE, APPROACH SIDEWALK TRANSITIONS, AND CURB RAMP CLEAR OF OBSTRUCTIONS THAT PROTRUDE ABOVE THE SURFACE.
 2. CROSSWALKS AND STOP LINES MAY BE MARKED OR UNMARKED, SEE PLANS.
 3. FOR NARROW ISLAND WIDTH, SEE PEDESTRIAN REFUGE ISLAND WALKWAY OPENING AT INTERSECTIONS DETAIL.
 4. FOR MEDIUM AND LARGE ISLAND WIDTH, SEE CURB RAMP TYPE 1 ON CD-404.
 5. CONSTRUCT CURB RAMP TYPES 1, 2, 3, 4, & 7 PERPENDICULAR TO CURBLINE, AS SHOWN.
 6. IF A CURB RAMP IS REQUIRED, THE LOCATION OF THE DETECTABLE WARNING SURFACE MUST BE AT THE BOTTOM OF THE RAMP AND WITHIN THE REQUIRED DISTANCE FROM THE RAIL.
 7. A STANDARD DETECTABLE WARNING (DWS) SURFACE IS NOT AVAILABLE TO FIT THIS APPLICATION, AND THEREFORE ONE WILL NEED TO BE CUSTOMIZED. THE DWS SHOULD COVER THE ENTIRE WIDTH OF THE RAMP, THE ROWS OF DOMES ON THE DWS SHOULD FOLLOW THE DIRECTION OF TRAVEL OF THE RAMP, SO PEDESTRIANS WHO USE MOBILE DEVICES CAN TRACK BETWEEN THE DOMES.

2 ADA DETECTABLE WARNINGS DETAILS

SCALE: NTS

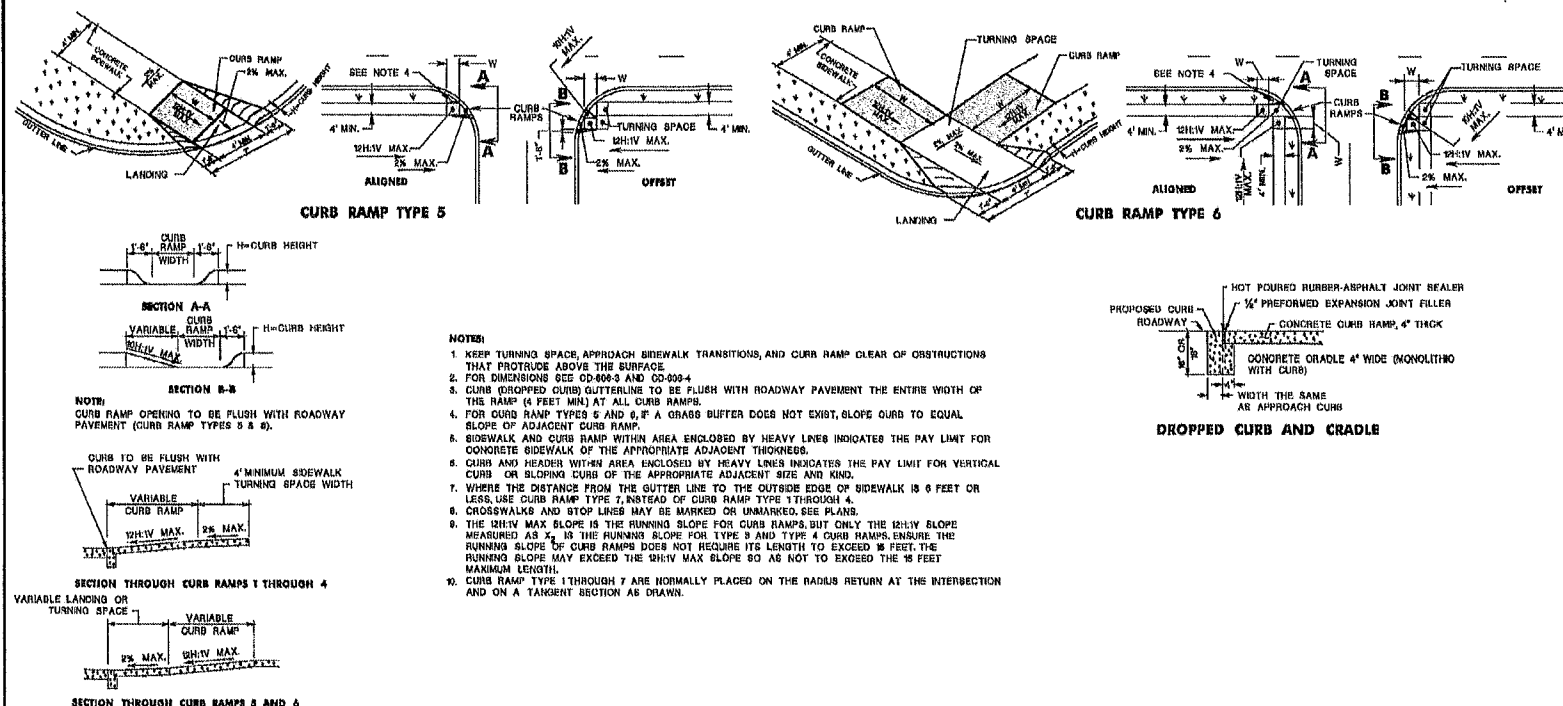

- NOTES:**
1. KEEP TURNING SPACE, APPROACH SIDEWALK TRANSITIONS, AND CURB RAMP CLEAR OF OBSTRUCTIONS THAT PROTRUDE ABOVE THE SURFACE.
 2. FOR DIMENSIONS SEE CD-404.3 AND CD-404.4.
 3. CURB (DROPPED CURB) OUTERLINE TO BE FLUSH WITH ROADWAY PAVEMENT THE ENTIRE WIDTH OF THE RAMP (4 FEET MIN.) AT ALL CURB RAMP.
 4. FOR CURB RAMP TYPES 5 AND 6, IF A GRASS BUFFER DOES NOT EXIST, SLOPE CURB TO EQUAL SLOPE OF ADJACENT CURB RAMP.
 5. SIDEWALK AND CURB RAMP WITHIN AREA ENCLOSED BY HEAVY LINES INDICATES THE PAY LIMIT FOR CONCRETE SIDEWALK OF THE APPROPRIATE ADJACENT THICKNESS.
 6. CURB AND HEADSTAY WITHIN AREA ENCLOSED BY HEAVY LINES INDICATES THE PAY LIMIT FOR VERTICAL CURB OR SLOPING CURB OF THE APPROPRIATE ADJACENT SIZE AND KIND.
 7. WHERE THE DISTANCE FROM THE GUTTER LINE TO THE OUTSIDE EDGE OF SIDEWALK IS 6 FEET OR LESS, USE CURB RAMP TYPE 7, INSTEAD OF CURB RAMP TYPE 1 THROUGH 4.
 8. CROSSWALKS AND STOP LINES MAY BE MARKED OR UNMARKED, SEE PLANS.
 9. THE 2% MAX. SLOPE IS THE RUNNING SLOPE FOR CURB RAMP, BUT ONLY THE 2% SLOPE MEASURED AS 1/4" IS THE RUNNING SLOPE FOR TYPE 5 AND TYPE 4 CURB RAMP. ENSURE THE RUNNING SLOPE OF CURB RAMP DOES NOT REQUIRE ITS LENGTH TO EXCEED 18 FEET. THE RUNNING SLOPE MAY EXCEED THE 2% MAX. SLOPE SO AS NOT TO EXCEED THE 18 FEET MAXIMUM LENGTH.
 10. CURB RAMP TYPE 1 THROUGH 7 ARE NORMALLY PLACED ON THE RADIUS RETURN AT THE INTERSECTION AND ON A TANGENT SECTION AS SHOWN.

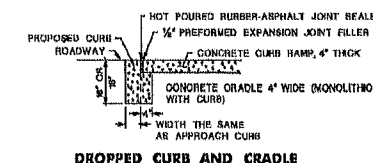

DROPPED CURB AND CRADLE

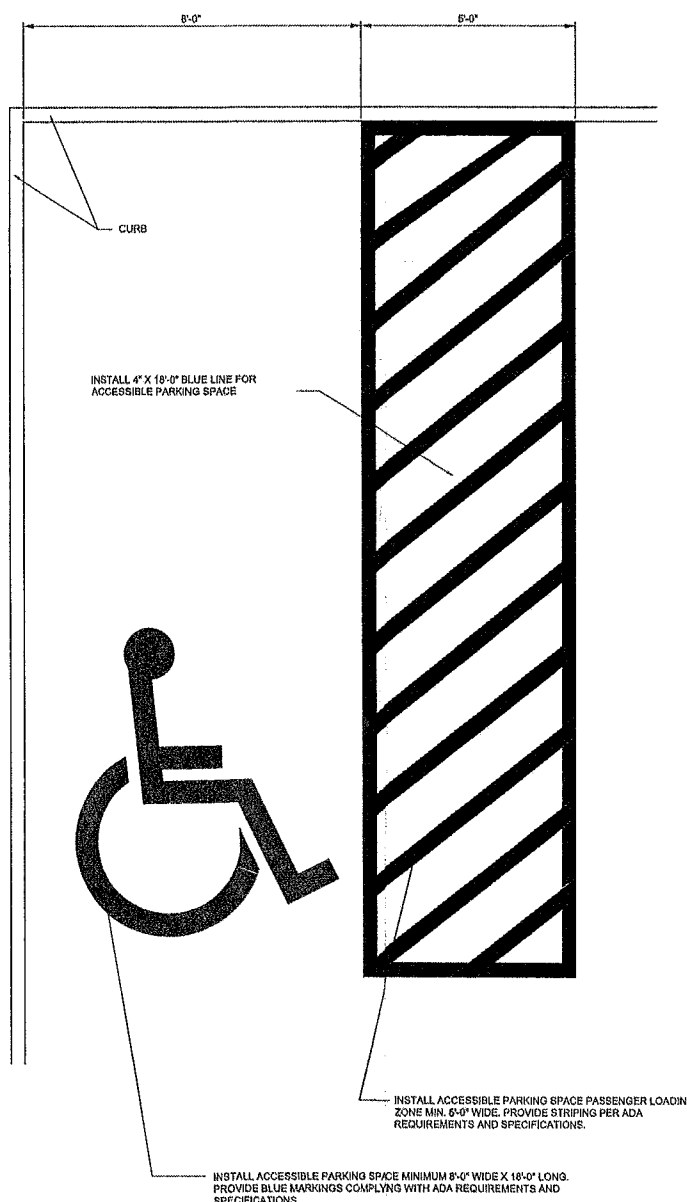

3 HANDICAP PARKING SPACE DETAIL

SCALE: 1/2"=1'-0"

1 TYPICAL SIDEWALK RAMP DETAIL

SCALE: NTS